

Ceramic Gas Filter with HASTELLOY® C-22 Housing for Corrosive Special Gas



High Corrosion Resistance

- HASTELLOY® C-22 is used for housing and ceramic for filter element. These elements have very high corrosion resistance against halogen series, such as HBr or HCl, reactive corrosive special gases and provide good performance.

Low Degas Characteristic

- Ceramic filter is suited for special gas applications such as corrosive or high reactive gases compared with stainless steel SUS316L filter due to its remarkably lower water absorption. Every filter is shipped after special cleansing by purified water and baking to perform superior degas characteristic.

High Accuracy Filtration : 0.003 μ m

- High accuracy filtration is achieved by multilayered ceramic element. Zero particle count of 0.003 μ m is checked by CNC counter for all products before shipment.

Specification

| | |
|---------------------------------------|---|
| Filtration Accuracy | 0.003 μ m |
| Recommended Flow Rate | 40 to 200L/min (refer to flow rate characteristic curve for each model) |
| Max. Operating Pressure | 17MPa (2,465PSIG) at 20°C 16.5MPa (2,392PSIG) at 120°C |
| Max. Allowable Differential Pressure | 9.6MPa(1,392PSIG) at 20°C |
| Max. Continuous Operating Temperature | 120°C |
| Baking Temperature | 200°C |
| External Leakage | 2×10^{-11} Pa · m ³ /sec or less |
| Materials | Housing: HASTELLOY®C-22 Roughness: Rmax0.7 μ m or less Element: Alumina ceramics(Al ₂ O ₃) Seal: PTFE |
| Joint | 1/4", 3/8", 1/2", 3/4" VCR®, Swagelok®, UPG®, and others |

Ceramic
Gas Filter

Flow Rate Characteristics

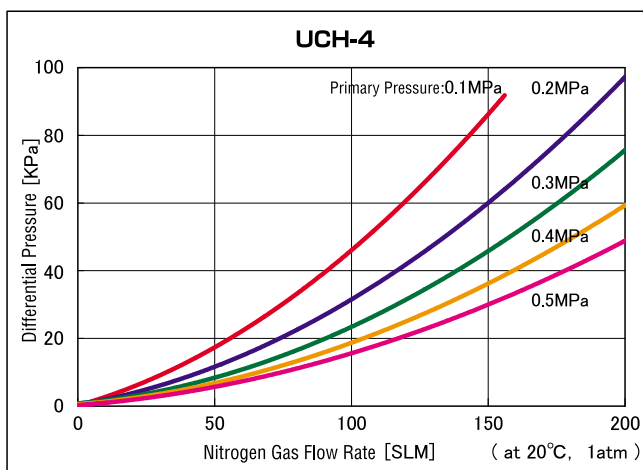
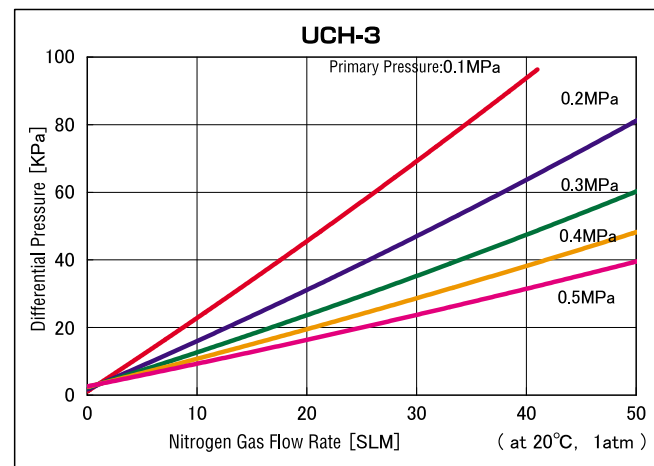
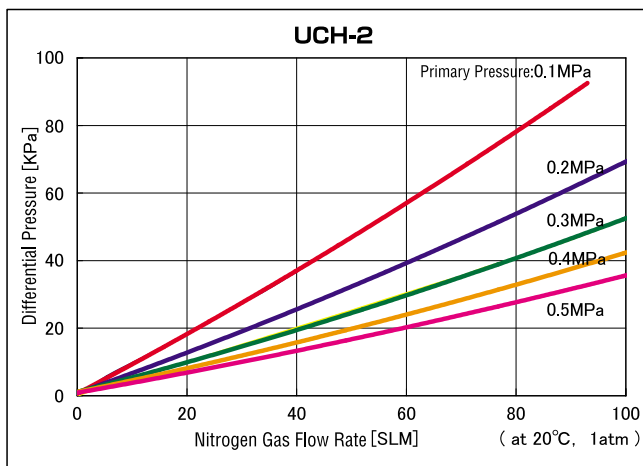

Dimensional Outline Drawings

UCH-2-02VR

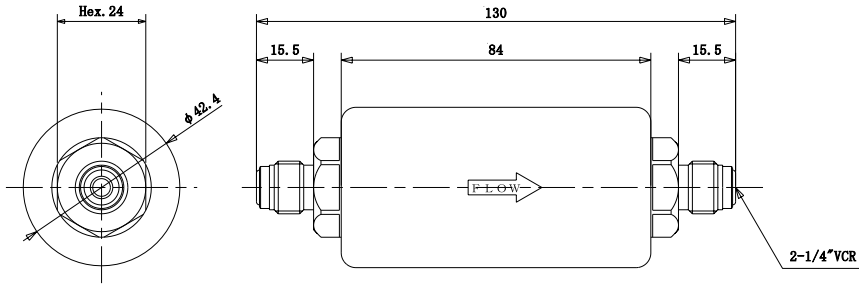

UCH-3-02VR

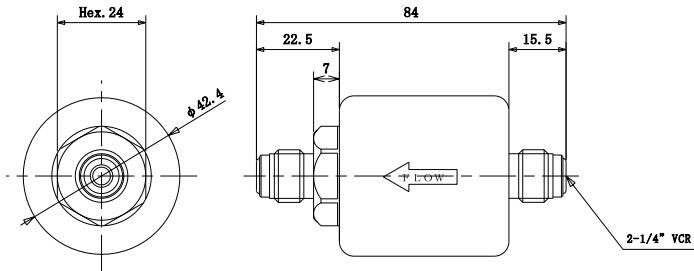

UCH-4-02VR

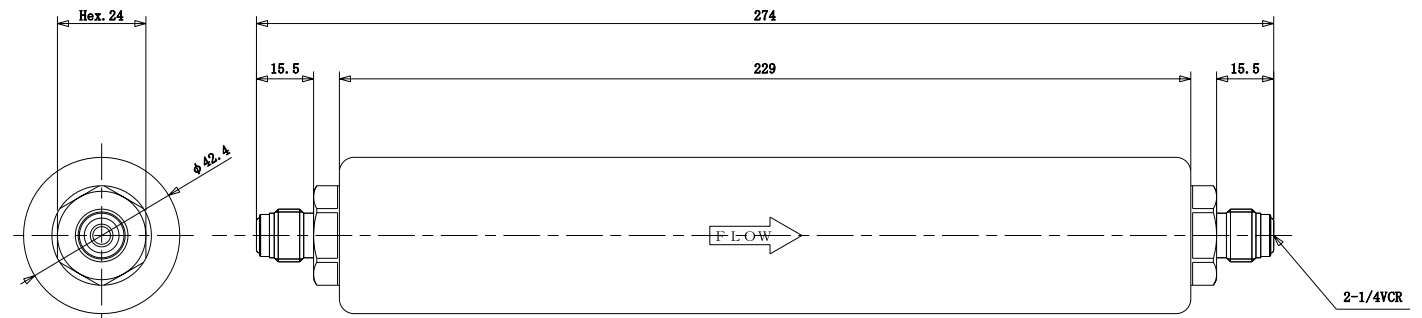

Dimensions

| Model | A(mm) | B(mm) | D(mm) | E(inch) | F(mm) | H(mm) |
|------------|-------|-------|--------|---------|-------|-------|
| UCH-2-02VR | 15.5 | 84.0 | Hex.24 | 1/4 | φ42.4 | 130.0 |
| UCH-2-02SW | 10.0 | 84.0 | Hex.24 | 1/4 | φ42.4 | 119.0 |
| UCH-2-03VR | 19.0 | 92.0 | Hex.24 | 3/8 | φ42.4 | 146.0 |
| UCH-2-03SW | 12.0 | 92.0 | Hex.24 | 3/8 | φ42.4 | 131.0 |
| UCH-3-02VR | 15.5 | 46.0 | Hex.24 | 1/4 | φ42.4 | 84.0 |
| UCH-3-02SW | 10.0 | 46.0 | Hex.24 | 1/4 | φ42.4 | 73.0 |
| UCH-3-03VR | 19.0 | 48.4 | Hex.24 | 3/8 | φ42.4 | 112.0 |
| UCH-4-02VR | 15.5 | 229.0 | Hex.24 | 1/4 | φ42.4 | 274.0 |
| UCH-4-03VR | 19.0 | 230.0 | Hex.24 | 3/8 | φ42.4 | 284.0 |

Ceramic
Gas Filter

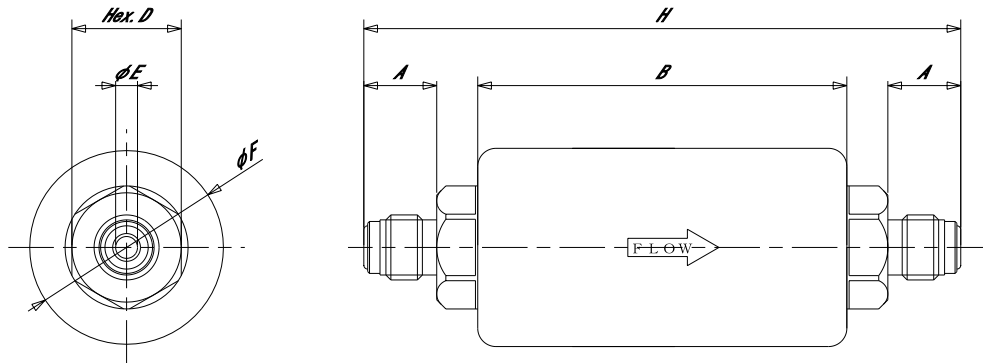

How to Order

UCH - **2** - **02** **VR**

Type

Bore Diameter

Type of Joint

Indication of Flow Rate

2 : 40 to 80SLM
3 : 10 to 40SLM
4 : 80 to 200SLM

02 : 1/4"
03 : 3/8"
04 : 1/2"
06 : 3/4"

VR : VCR®
SW : Swagelok®
UP : UPG®
For other joints,
please contact us.

※Specification is subject to change without notice.